

1000
D43192
CT 6067/668



HUGHES COURT

346
D24008
CT 5181/556

511 (Reserve)
D23301
CT 5520/196

333
D23301
CT 5350/992

332
D23301
CT 5384/738

YOUNG
STREET

EDUCATION
COURT

PRELIMINARY PLAN

23/0019

PLAN UNDER THE ROADS (OPENING & CLOSING) ACT, 1991

TITLE REFERENCE FOR ROAD N/A

IRRIGATION AREA DIVISION
HUNDRED ... NOARLUNGA
AREA ... SHEIDOW PARK
COUNCIL ... CITY OF MARION

SCALE METRES
0 5 10 20 30 40

STATEMENTS CONCERNING EASEMENTS ANNOTATIONS
AND AMENDMENTS

ROAD TO BE CLOSED LETTERED A

CLOSED ROAD 'A' TO BE MERGED WITH CT 6164/346.

TO BE SUBJECT TO AN EASEMENT TO TELSTRA — — —

AERIAL PHOTO SUPPLIED BY METROMAP DATED 22/02/2023

CERTIFIED CORRECT AS TO INTENT

DATED 29/08/2023

CITY OF MARION

I HEREBY CERTIFY THAT THE PORTION OF ROAD TO BE CLOSED
HEREON IS ROAD WITHIN THE MEANING OF SECTION 3 OF THE
THE ROADS (OPENING & CLOSING) ACT, 1991

AUTHORITY REFERENCE: PUBLIC MAP

18/8/2023

DAMIAN HOLLAND
LICENSED SURVEYOR

Alexander & Symonds Pty.Ltd.

11 KING WILLIAM STREET, KENT TOWN
P.O. BOX 1000 KENT TOWN 5071
Tel (08) 8130 1666 Fax (08) 8362 0099 A.B.N. 93 007 753 988

REFERENCE 23A0545 Prelim(B)
JEA 12.07.2023

LOCATION PLAN



C40206

SHEET 2 OF 3

45825_pland_1_V01_Version_3

BEARING DATUM: ①-② 175°09'30"
DERIVATION: F58160 ADOPTED

TOTAL AREA: 4507m²

ENLARGEMENT A2



N

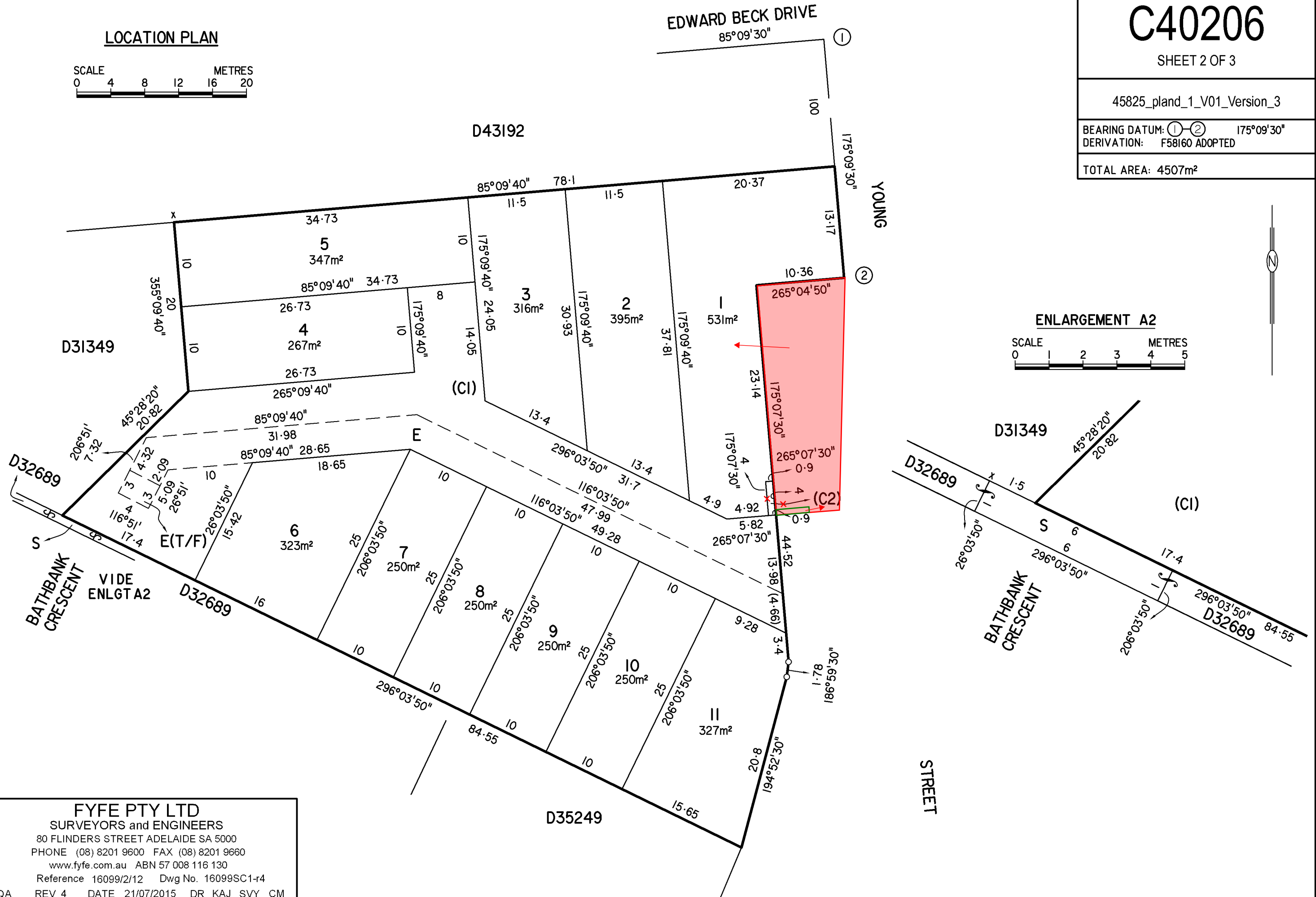

FYFE PTY LTD

SURVEYORS and ENGINEERS

80 FLINDERS STREET ADELAIDE SA 5000

PHONE (08) 8201 9600 FAX (08) 8201 9660

www.fyfe.com.au ABN 57 008 116 130

Reference 16099/2/12 Dwg No. 16099SC1-r4

QA REV 4 DATE 21/07/2015 DR KAJ SVY CM