

PRELIMINARY PLAN No 24/0020

YORKE PENINSULA COUNCIL HUNDRED OF COONARIE FOUL BAY



IMPORTANT NOTE: This plan was prepared for public inspection as a preliminary proceeding for a Road Process Order, and the information on this plan is not suitable for any other purpose.

The property description, road identification and other features have been compiled from existing information and have not been verified by field survey.

The plan may change when other information becomes available under the Road Process Order.

In particular, no reliance should be placed on the information on this plan for detailed subdivision design or for any financial dealings involving this land.

This note is an integral part of this plan.

IMAGERY DERIVED FROM SOUTH AUSTRALIAN PROPERTY AND PLANNING ATLAS
DATED: 2018

ROAD TO BE CLOSED LETTERED A
CLOSED ROAD A TO BE RETAINED BY THE CROWN

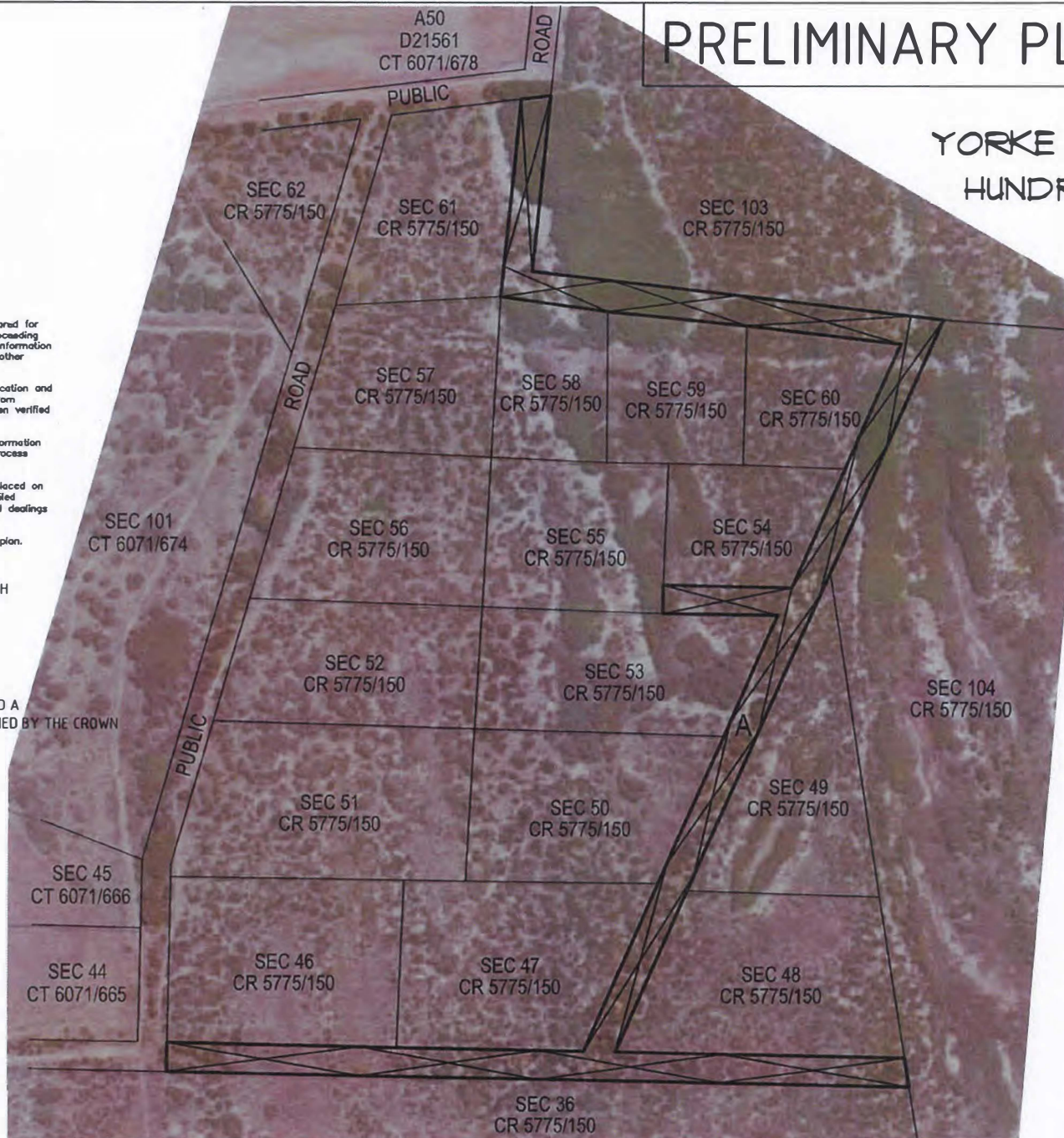

APPROVED BY THE YORKE PENINSULA COUNCIL
DATED THIS 24 DAY OF April, 2024

SIGNED: 
TITLE: Director Development Services

I HEREBY CERTIFY THAT THE PORTION OF ROAD TO BE CLOSED LETTERED A HEREON IS PUBLIC ROAD WITHIN THE MEANING OF SECTION 3 OF THE ROADS (OPENING AND CLOSING) ACT, 1991.
(AUTHORITY: DBP 7 HUNDRED OF COONARIE)

 DATE: 12/4/24
JESSE EVANS
LICENSED SURVEYOR

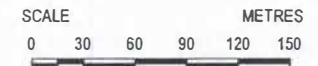

REF: K24057P1.0 DATE: 4/04/24 JTE,MDC



KADINA
6 Graves Street SA 5554
08 8821 3544
info@mosel.com.au
mosel.com.au
ACN 144 516 398

CLARE
08 8842 1228
ADELAIDE &
MURRAY BRIDGE
1300 853 203